

GHOSTDRONE2.0 AERIAL

Quick Start Guide

1. Download the EHANG Play APP



iPhone/iPad: Please search "EHANG Play" in App Store

Android: Please search "EHANG Play" in Google Play

2. Charge the Smart Flight Battery and the G-BOX

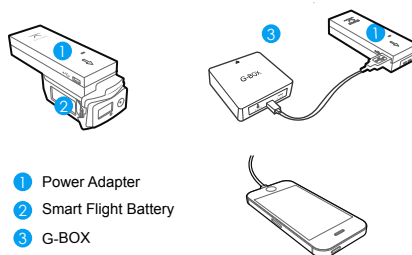

① Power Adapter

② Smart Flight Battery

③ G-BOX

The minimum battery requirement for your first flight:

>=70%: Smart Flight Battery



>=90%: G-BOX



>=40%: Mobile Device



3. Connect your phone to GHOSTDRONE according to the instructions in the APP

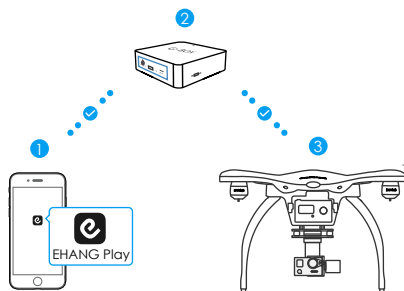

4. Install the propellers and follow the instructions in the APP for your first flight

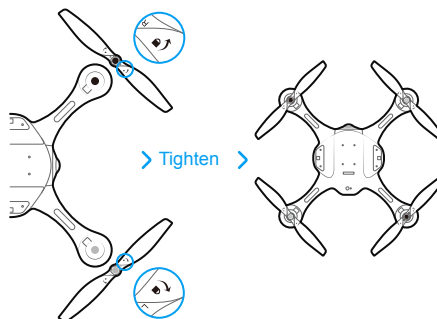

Note

After sign up and log in, click the "🕒" in the upper left corner to watch the tutorials.

For your first flight, please take the GHOSTDRONE outdoors and follow the instructions in the APP.

For your safety, Avatar Mode will be unlocked after you have flown in Touch-to-go Mode for 3 times.

For your first flight, please follow the minimum battery requirement: **Smart Flight Battery >=70%**, **G-BOX >= 90%**, **Mobile Device >= 40%**.

--GHOSTDRONE AERIAL Checklist--

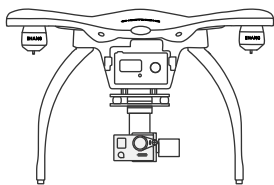

Copter (including Smart Flight Battery,
3D Gimbal, 4K Sport Camera (free)
and Landing Gear) x 1

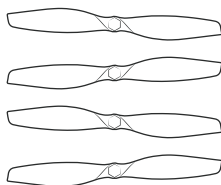

Propeller x 8

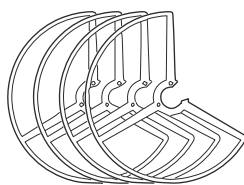

Propeller Guard x 4

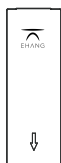

Power Adapter ×1



G-BOX ×1



Data Pack×1

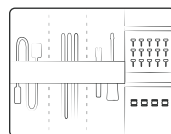

Tool Kit ×1

Note:

The tool kit includes: Battery Charging Cable x 1, Micro USB cable x 1, Wrench x 1, Hex Screwdriver x 1, Socket Cap Screw x 15, Damper x 4.

The Micro USB cable can be used for charging the G-BOX, and updating the GHOSTDRONE firmware.

EHANG

Guangzhou EHang Intelligent Technology Co., Ltd.
ENTERPRISE STANDARD: Q/ EHT 001-2017

Contact Us

Business Hour: Monday – Friday 9:00 A.M – 5:00 P.M (PST)

Customer Service Phone: +1 650-533-8554 / 888-800-7056

Customer Service Email: support@ehang.com

If there are any updates to the quick start guide in the future, please see the latest version on official website: www.ehang.com/download/

EHang, Inc. reserves all rights to interpret this manual.

GHOSTDRONE2.0 云台版

快速入门指南

1.扫描二维码，下载EHANG Play APP



苹果设备：请到 AppStore 中搜索 EHANG Play
安卓设备：请到应用商店中搜索 EHANG Play

2.给设备充电及检查电量



- ① 电源适配器
- ② 智能飞行电池
- ③ G-BOX

首次飞行前请确保：
智能飞行电池电量 $\geq 70\%$ ✓
G-BOX 电量 $\geq 90\%$ ✓
手机电量 $\geq 40\%$ ✓

3.请根据APP提示，按步骤连接飞机

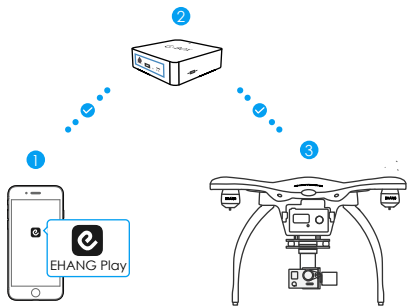

4.飞行前安装螺旋桨，按APP提示开始首次飞行

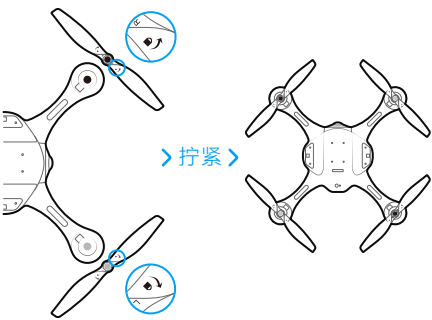

⚠ 注意事项

- 注册登录 APP 后，请点击主界面左上角的“📺”观看教学视频，建议在 Wi-Fi 环境下观看。
- 请将飞行器携带至空旷场地，根据 APP 新手指引飞行步骤及完成您的首次飞行。
- 阿凡达模式需先在指点飞行模式下熟悉操作3次后，即可解锁阿凡达飞行模式。
- 初次飞行，请务必确保**电池电量 $\geq 70\%$ ；G-BOX 电量 $\geq 90\%$ ；手机电量 $\geq 40\%$ 。**

——云台版清单——

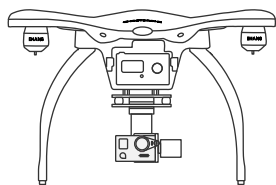

飞行器（含电池、云台、
相机（赠送）、脚架）× 1

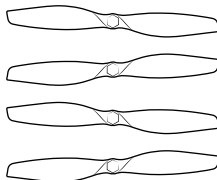

螺旋桨 × 8

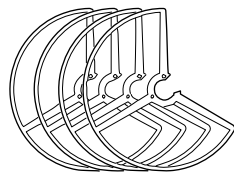

护圈 × 4



电源适配器 × 1



G-BOX × 1



资料包 × 1

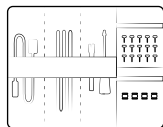

配件包 × 1

注：

配件包内含：充电线 × 1、USB 线 × 1、扳手 × 1、螺丝 × 15，螺丝刀 × 1，减震球 × 4；
USB 充电线可以为 G-BOX 充电，亦可用于刷新固件时连接飞行器和电脑。

EHANG | 亿航

广州亿航智能技术有限公司
企业标准：Q/ EHT 001-2017

联系我们

官网：www.ehang.com
官方微信：EhangUAV
官方微博：亿航智能

服务邮箱：service@ehang.com
售后热线：400-622-1638
服务时间：周一至周五 9:00-18:00（法定节假日除外）

更新说明

详细操作说明请往亿航官网查看：www.ehang.com/cn/download/
本指南内容如有更新，恕不另行通知。
最终解释权归广州亿航智能技术有限公司所有

